

INTEX® OWNER'S MANUAL

Quick-Fill™ Electric Air Pump, Model AP642

220 – 240 Volt ~ 50 Hz; 12 Volt DC; Rechargeable Battery

READ AND FOLLOW ALL INSTRUCTIONS BEFORE USING THIS PRODUCT

166
IO



WARNING

- Adult use only.
- Do not drop unit into water or expose unit to rain or water.
- Do not direct air stream at face or body.
- Do not operate for more than 10 minutes at a time. Unplug and let cool at least 30 minutes.
- Unplug unit when not in use.
- Do not obstruct vent holes or open source.
- Do not insert objects into the inflation or deflation connector.
- To reduce the risk of electric shock, do not expose to rain. Store indoors.
- This appliance can be used by children aged from 8 years and above and persons with reduced physical, sensory or mental capabilities or lack of experience and knowledge if they have been given supervision or instruction concerning use of the appliance in a safe way and understand the hazards involved.
- Children shall not play with the appliance.
- Cleaning and user maintenance shall not be made by children without supervision.
- The appliance is only to be used with the power supply unit provided with the appliance. It must only be supplied at safety extra low voltage corresponding to the marking on the appliance.

**FOLLOW THESE RULES AND ALL INSTRUCTIONS TO
AVOID PROPERTY DAMAGE, ELECTRIC SHOCK, BURNS
OR OTHER INJURY.**

SAVE THESE INSTRUCTIONS

NAMES OF PARTS

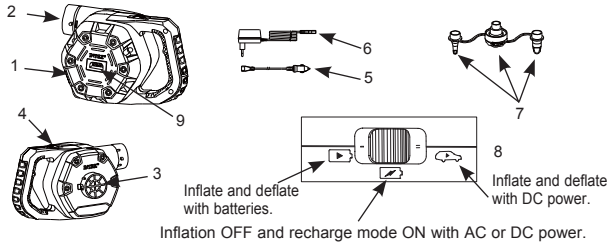

PARTS DESCRIPTION:

1. PUMP
2. INFLATION CONNECTOR
3. DEFLATION CONNECTOR
4. SWITCH
5. DETACHABLE 12V DC POWER CORD
6. AC ADAPTER
7. NOZZLES
8. SWITCH OPERATION DETAIL
9. VENT HOLES / SLOTS

INSTRUCTIONS

General

- Pump must be charged before use and is not designed for inflation directly from household AC power sources.
- It is recommended that the first charge to be 10 hours or overnight using the AC adapter powered by household 220-240 AC voltage.
- If necessary, the initial charge can be made using the DC power Cord plugged into an automobile cigarette lighter or 12V DC accessory receptacle for one hour. After the first charge, it may be used for inflation (without cords) and recharged using either the AC Adapter or Fast-charged (1 hour only) using the 12 Volt DC Power Cord. See specific instructions below.
- The external flexible cable or cord of this transformer cannot be replaced. If the cord is damaged, the transformer shall be scrapped.
- The " [] " position turns the pump OFF and is also the RECHARGE mode position.
- The batteries are permanently sealed in the pump and cannot be removed or replaced. As the pump weakens from use, recharge the batteries. Do not wait until they are fully discharged.
- Do not dispose of airpump and its batteries in a fire. Check your local regulations for proper disposal instructions.
- The battery must be removed from the appliance before it is scrapped.
- The appliance must be disconnected from the supply mains when removing the battery.
- The battery is to be disposed of safely.
- Keep away from heat or direct sunlight.
- Return pump, DC power cord, AC adapter and nozzles to package when not in use.
- No specific air pump maintenance is required.

CHARGE/RECHARGE INSTRUCTIONS

Charging the pump by AC adapter using household 220-240 AC voltage:

1. The pump must be charged for 10 hours or overnight with AC adapter powered by household 220-240 AC voltage.
2. Plug the AC adapter power cord into the air pump power receptacle (FIG. 1).
3. Plug the other end of the AC adapter power cord into a household 220-240 Volt AC electrical outlet (FIG. 2).
4. Faites glisser l'interrupteur sur la position " [] " pour charger/recharger les batteries. (FIG. 3).
5. Initial Charge: Charge the pump for ten (10) hours or overnight with household AC voltage.
6. When the pump is fully charged, remove the power cord (FIG. 4).

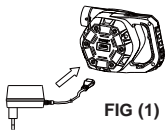

FIG (1)

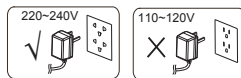

FIG (2)

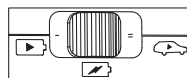

FIG (3)

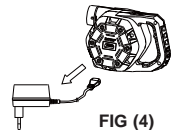

FIG (4)

Charging the pump using a standard automobile 12 Volt DC power source:

1. The pump must be charged for 1 hour with 12 Volt DC power source.
2. Plug the 12 Volt DC power cord into the air pump power receptacle (FIG. 5).
3. Attach the DC power cord plug into a standard 12 Volt DC automobile cigarette lighter or 12V DC accessory outlet (FIG. 5).
4. Slide the switch to " [] " position to charge/recharge the batteries (FIG. 3).
5. Charge: Charge the pump for 1 hour with 12 Volt DC power source.
6. When the pump is charged, immediately remove the power cord.

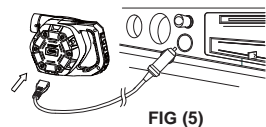

FIG (5)

NOTE: The LED light turns red during charging/recharging mode. If the LED light does not light up, make sure the switch is in the " [] " position.

SAVE THESE INSTRUCTIONS

INFLATION

When inflating large items such as inflatable boats and large air mattresses, no accessory nozzle (**FIG. 6**) may be needed. The air pumps inflation connector may fit directly into the inflation valve. If a nozzle is needed, use the air pump nozzle most appropriately sized for the product, then follow the instructions below:

166
IO

Inflation using the 12 Volt DC power cord:

1. Plug the 12 Volt DC power cord into the air pump power receptacle (**FIG. 5**).
2. Attach the DC power cord plug into a standard 12 Volt DC automobile cigarette lighter or accessory outlet (**FIG. 5**).
3. Attach the air pump inflation connector with nozzle if appropriate to the inflation valve on the item to be inflated (**FIG. 7**).
4. Slide the switch to "▶" position to operate the air pump (**FIG. 8**). Inflate item to desired level.
5. When the item is inflated, slide the switch to "◀" position to turn off the air pump (**FIG. 3**). Immediately unplug air pump and cords when air pump is not in use.

FIG (6)

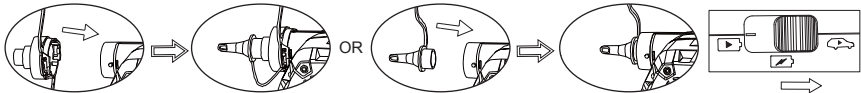

FIG (7)

FIG (8)

Inflation using the air pump when fully charged (without power cord):

1. Attach the air pump inflation connector with nozzle if appropriate to the inflation valve on the item to be inflated.
2. Slide the switch to "▶" position to operate the air pump (**FIG. 9**). Inflate item to desired level.
3. When the item is inflated, slide the switch to "◀" position to turn off the air pump.



FIG (9)

DEFLATION

Deflation using the 12 Volt DC power cord:

1. Follow steps 1 & 2 under DC power inflation instructions.
2. Attach the air pump deflation connector with nozzle if appropriate to the deflation valve on the item to be deflated (**FIG. 10**).
3. Slide the switch to "▶" position to operate the air pump. Deflate item to desired level.
4. When the item is deflated, slide the switch to "◀" position to turn off the air pump (**FIG. 3**). Immediately unplug air pump and remove the cord when air pump is not in use.

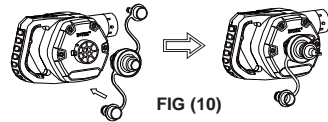

FIG (10)

Deflation using the air pump when fully charged (without power cord):

1. Attach the air pump deflation connector with nozzle if appropriate into the deflation valve on the item to be deflated.
2. Slide the switch to "▶" position to operate the air pump. Deflate item to desired level.
3. When the item is deflated, slide the switch to "◀" position to turn off the air pump.



©2018 Intex Marketing Ltd. - Intex Development Co. Ltd. - Intex Recreation Corp. All rights reserved/Tous droits réservés/Todos los derechos reservados/Alle Rechte vorbehalten. Printed in China/Imprimé en China/Gedruckt in China.
 ®™ Trademarks used in some countries of the world under license from/®™ Marques utilisées dans certains pays sous licence de/Marcas registradas utilizadas en algunos países del mundo bajo licencia de/Warenzeichen verwendet in einigen Ländern der Welt in Lizenz von/Intex Marketing Ltd. tota/al an Intex Development Co. Ltd., G.P.O. Box 28829, Hong Kong & Intex Recreation Corp., P.O. Box 1440, Long Beach, CA 90801 • Distributed in the European Union by/Distribué dans l'Union Européenne par/Distribuido en la Unión Europea por/Vertrieb in der Europäischen Union durch/Intex Trading B.V., Venneveld 9, 4705 RR Roosendaal - The Netherlands
 www.intexcorp.com

SAVE THESE INSTRUCTIONS